

Town of Morse Community Survey 2016 – Results & Discussion

Town of Morse Public Meeting
8/10/2016, 6PM

Background

- Contributing to Town efforts to update their Comprehensive Plan
- Survey looked at themes of **land use/zoning, housing, economic development, community services/facilities, and agricultural, natural and cultural resources**
- 164 respondents
- Results based on total answers per question

Demographics

- Average age of respondent: 61
- Residency:
 - Year-round resident (54%)
 - Non-resident landowner (35%)
 - Summer resident (10%)

General Information

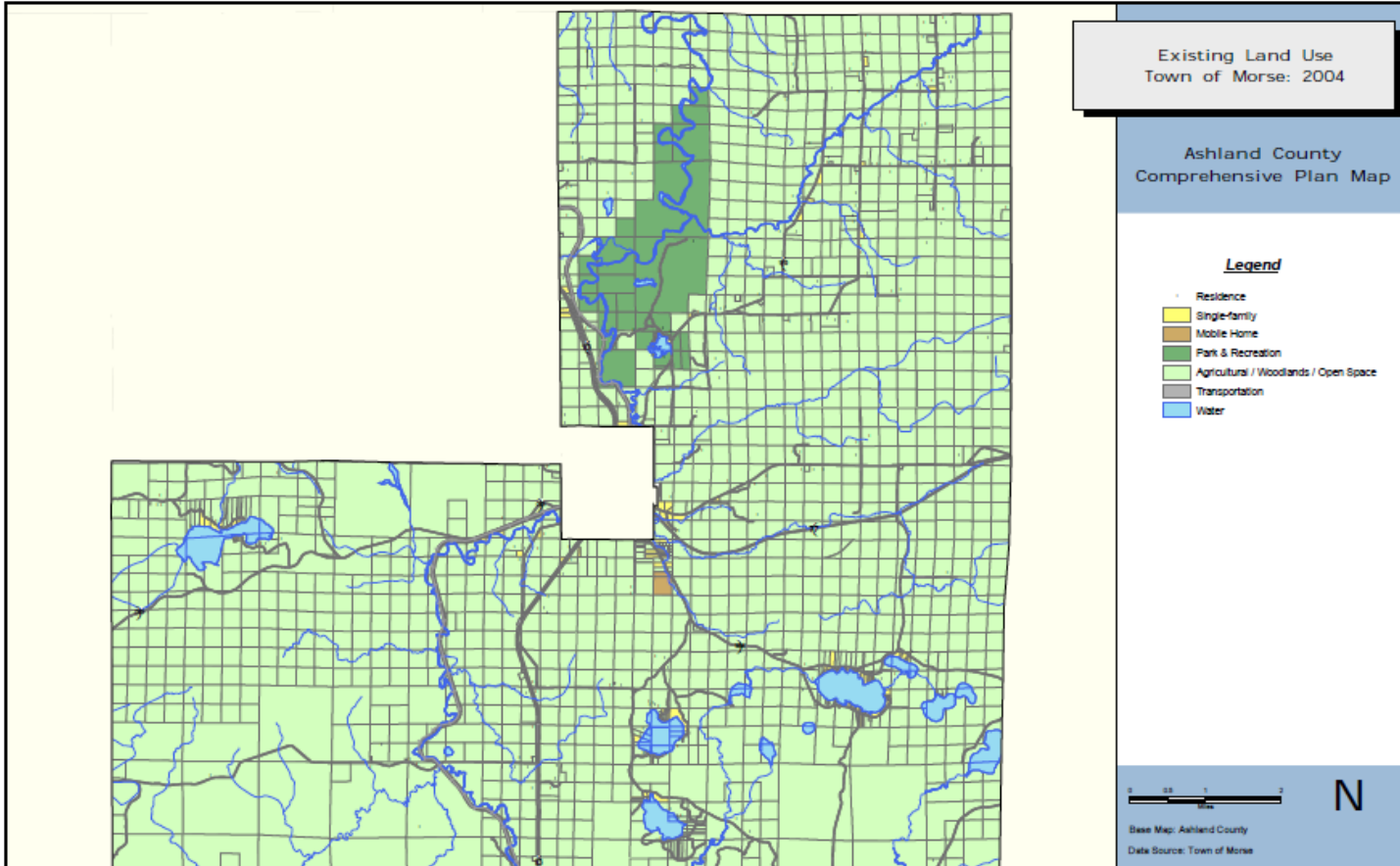

Top Reasons for Living in a Rural Area

Not a reason (1) → Slightly Important (2) → Important (3) → Very Important Reason(4)

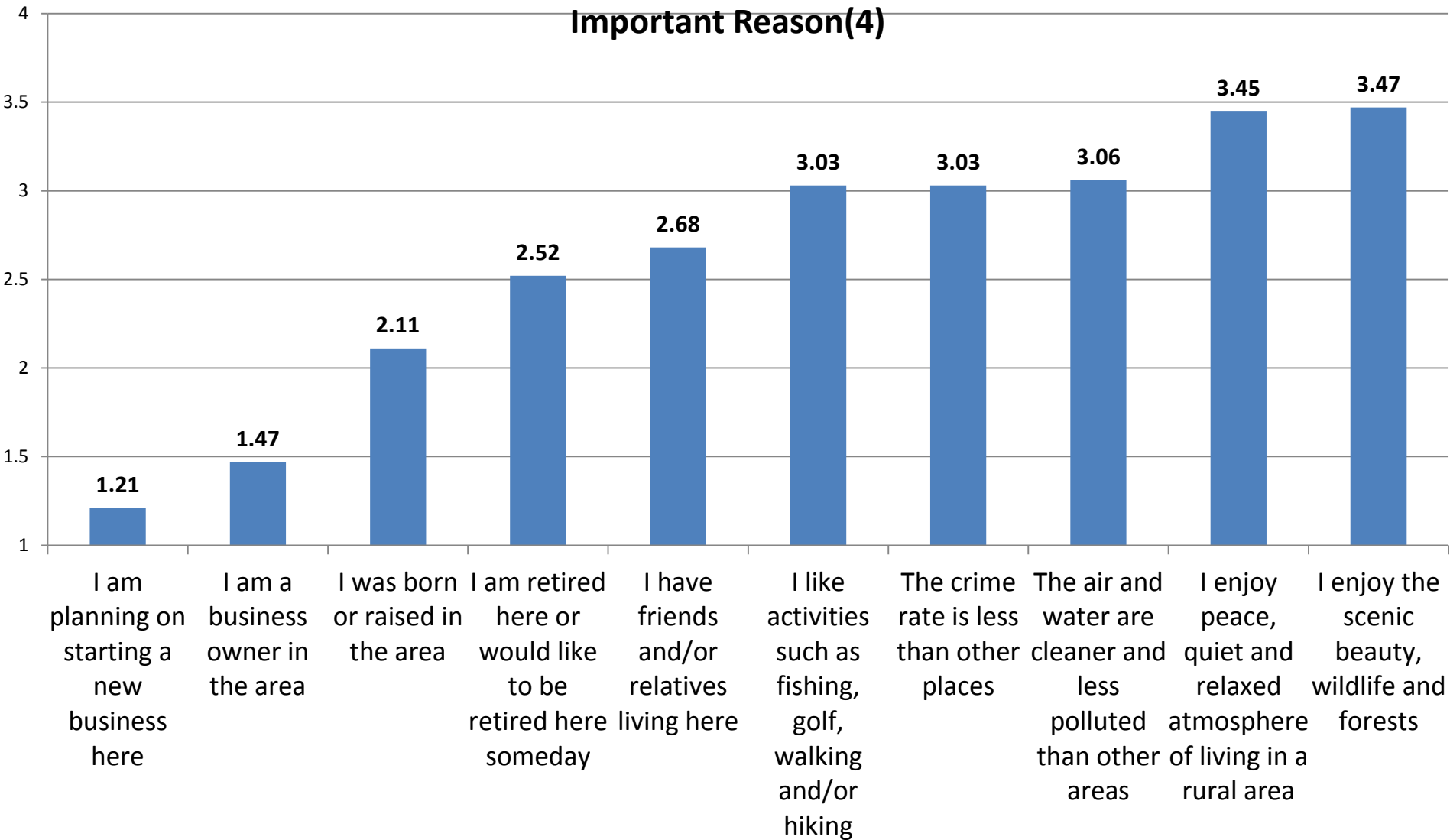

Land Use/Zoning



Source: visitashland.com



Source: allelectricsolar.com



Source: westernfarmpress.com



Source: safcosecurity.com

Attitude Toward Land Use/Zoning Elements

Strongly Agree (1) → Strongly Disagree (4)

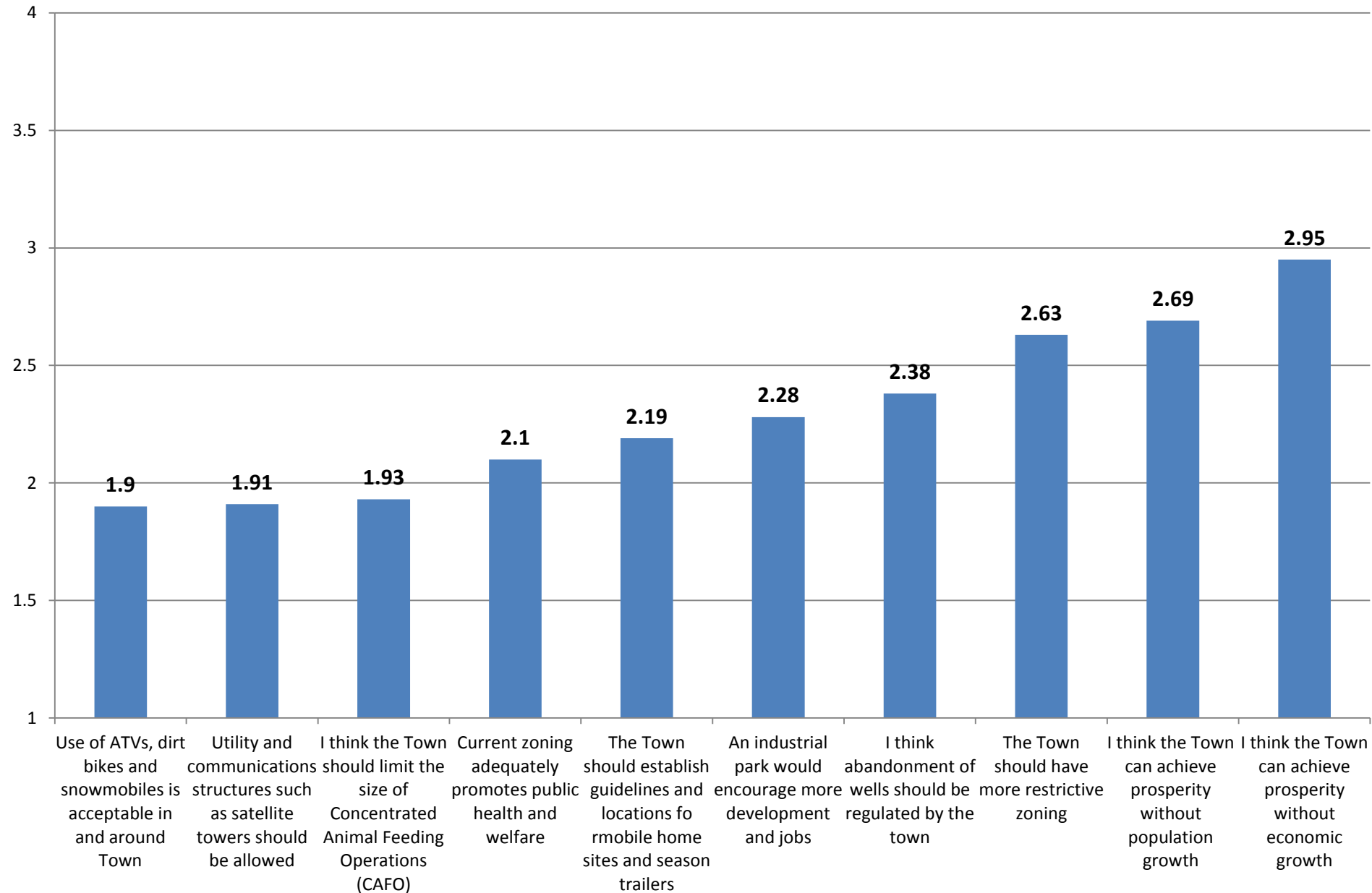

I think the Town should limit the size of Concentrated Animal Feeding Operations (CAFO)

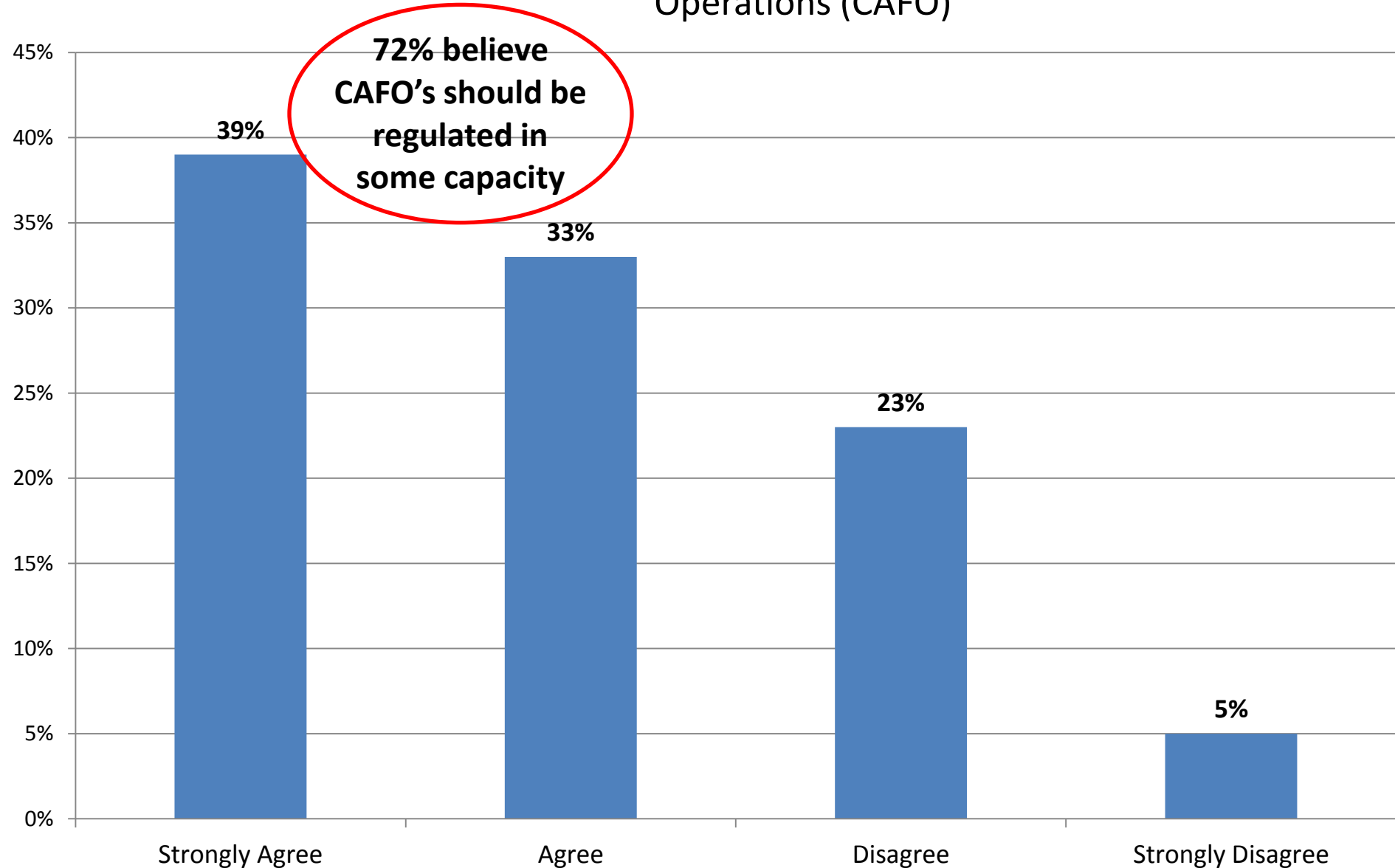

**Attitude Towards Types of Housing Development would like to see Town
Encourage**
Strongly Agree (1) --> Strongly Disagree (4)

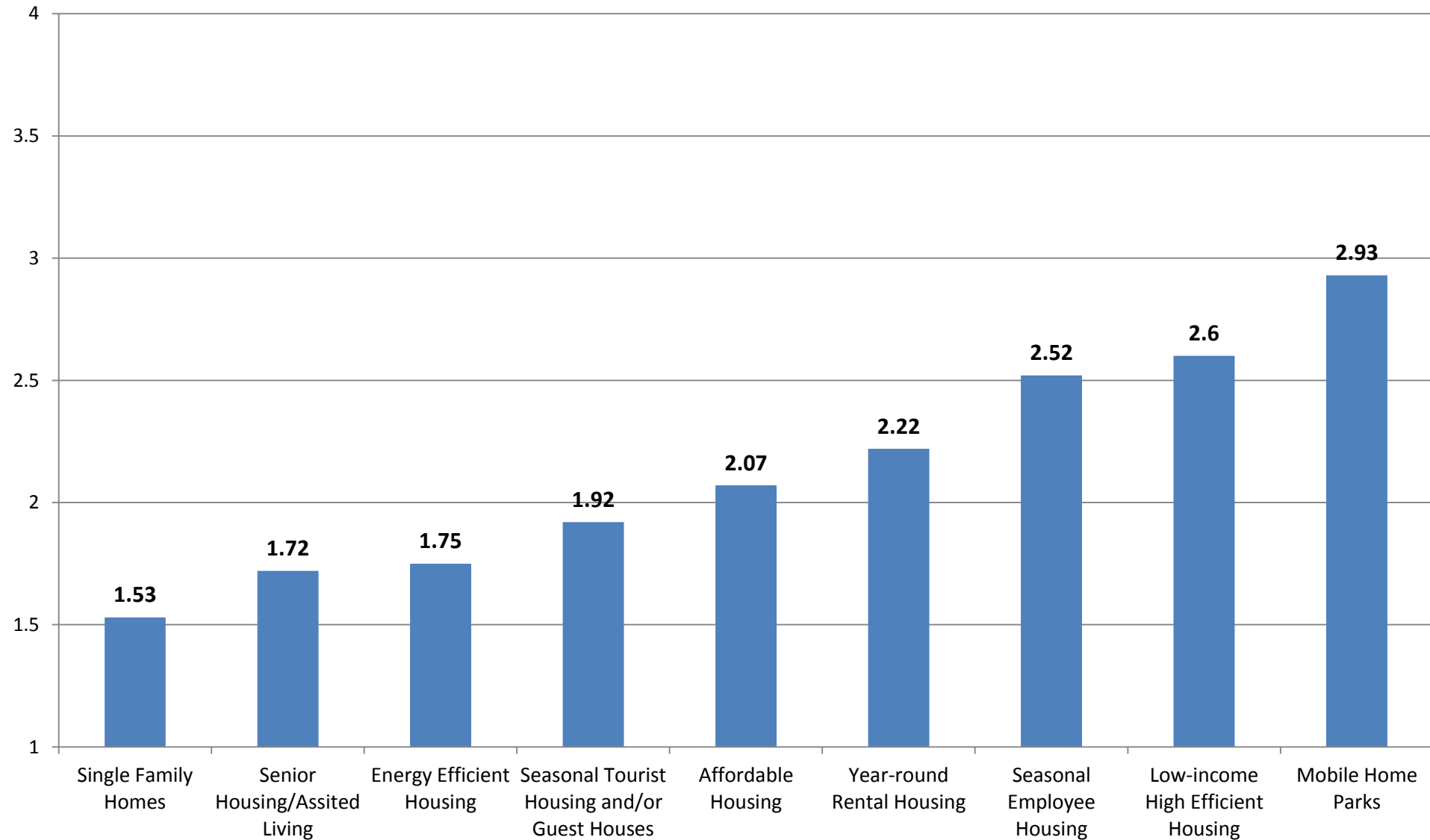

“Town should regulate CAFOs and industrial types of agriculture to provide maximum protection to lakes, rivers and well water. Impact on public health and well-being of residents can be adversely affected from pollution, smell and noise.”

Transportation



Source: Gunnarbikes.com

Quality of Blacktopped Roads

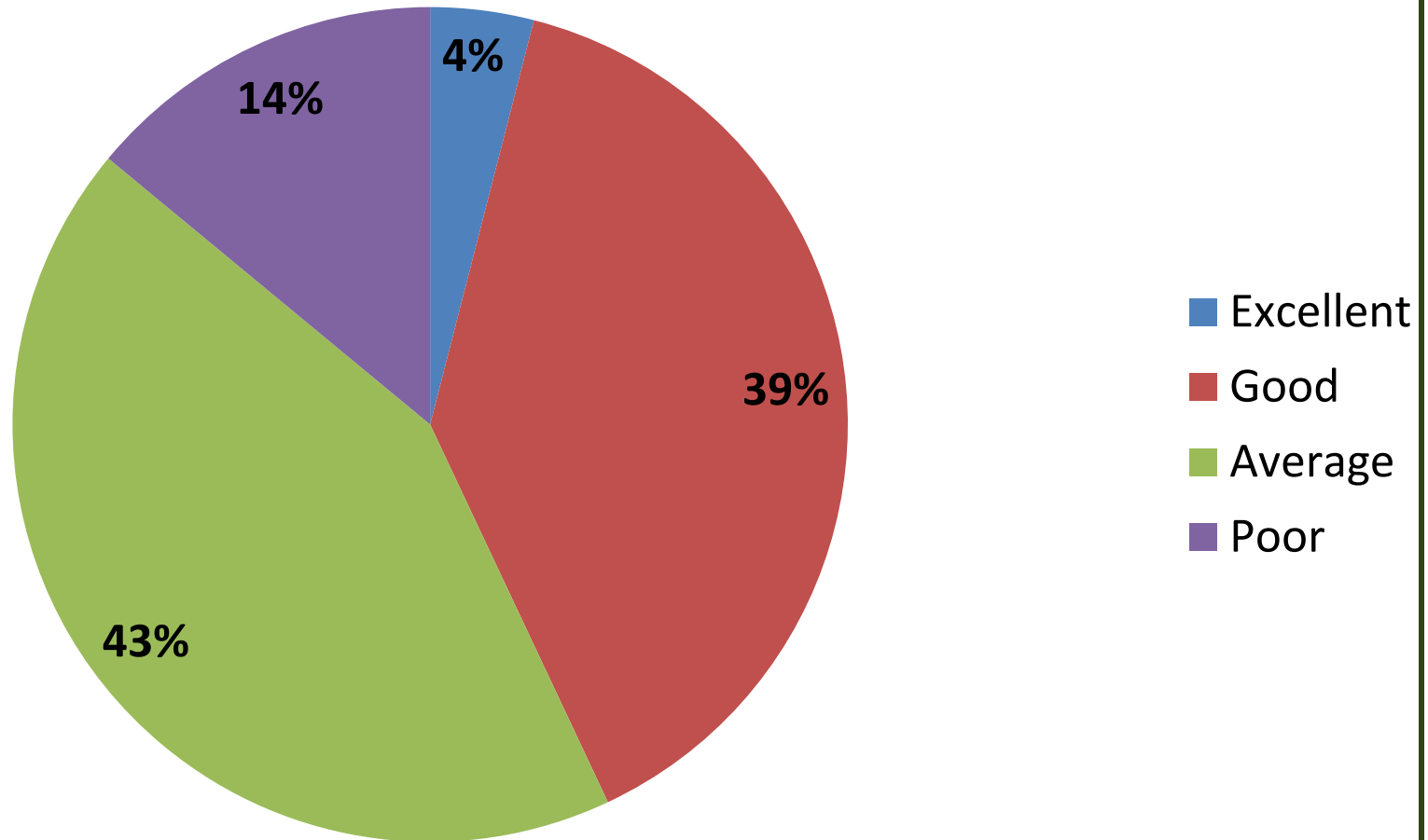

Quality of Gravel Roads

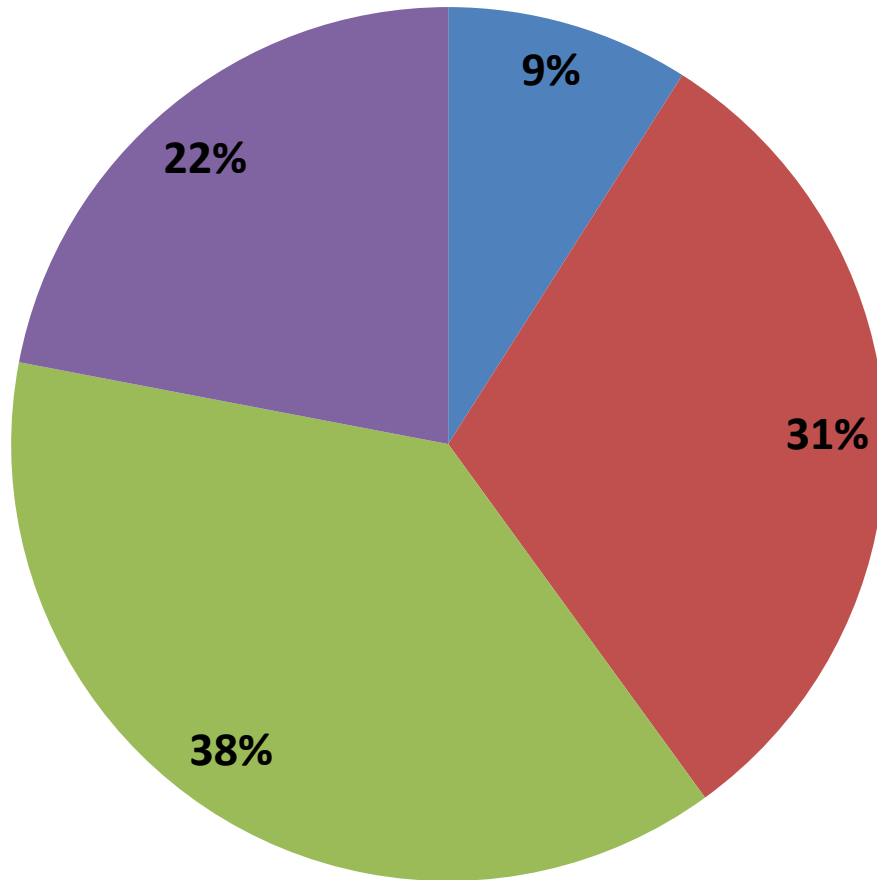

- Excellent
- Good
- Average
- Poor

“Gravel roads are average to poor much of the year, but good during the late summer and fall. Public transportation options should be explored”

Economic Development



Source: Bayfield Foods



Wildwoodhaven.com



Source: techcrunch.com

Types of Economic Development that Should be Pursued in the Town

Strongly Agree (1) → Strongly Disagree (4)

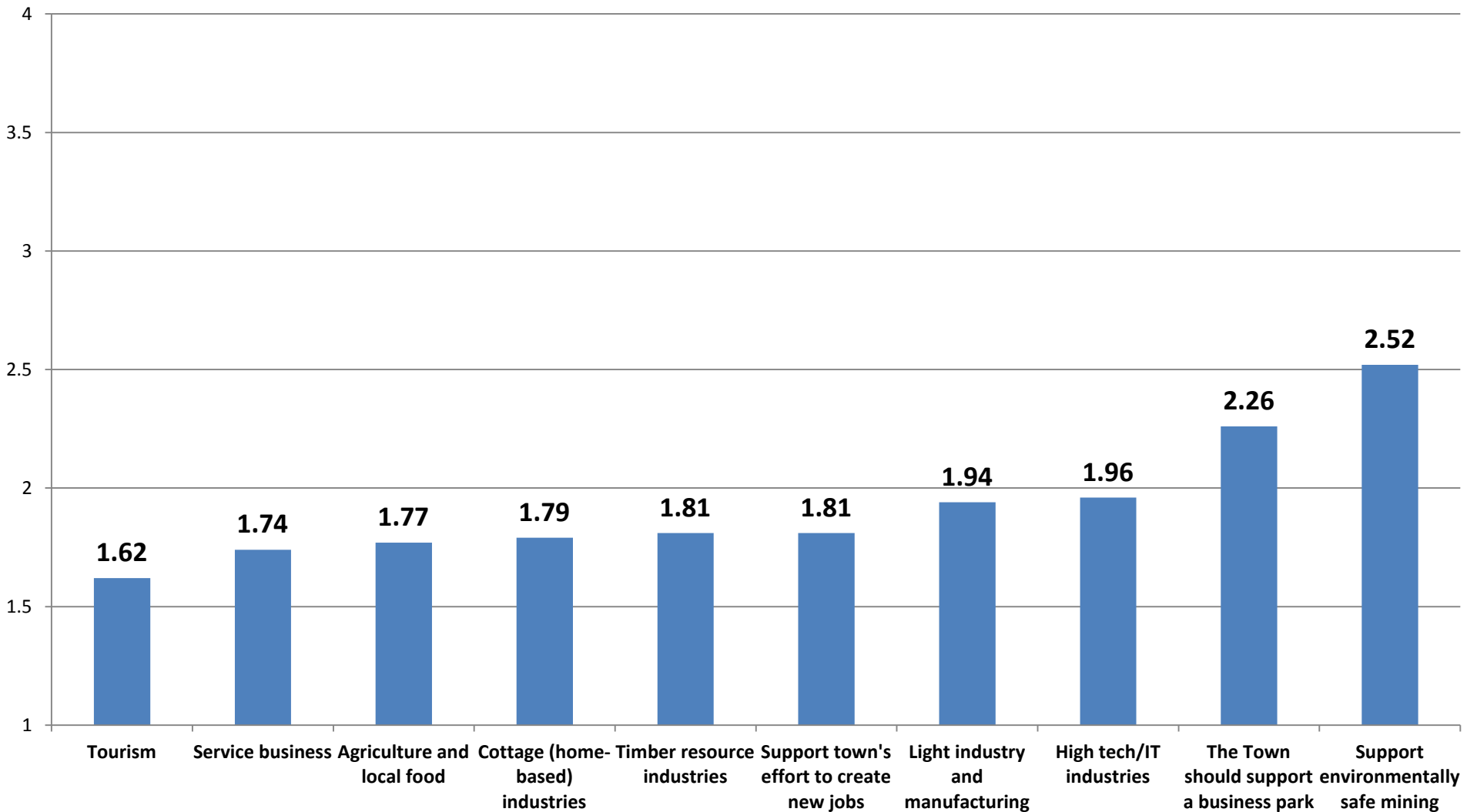

Support Environmentally Safe Mining

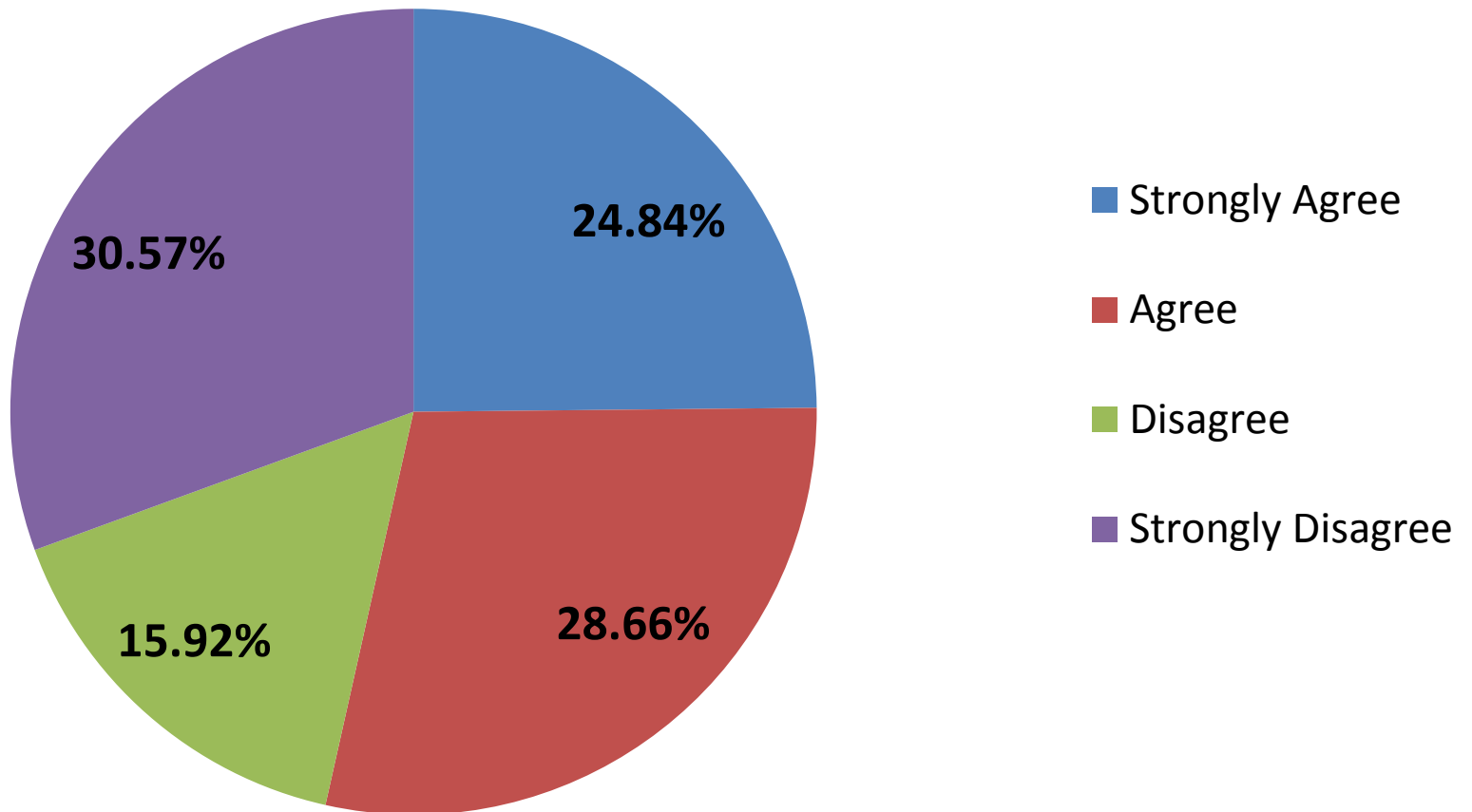

**Economic Development: Attitudes towards Activities Town Economy
might be Based
Greatly Encourage (1) → Greatly Discourage (4)**

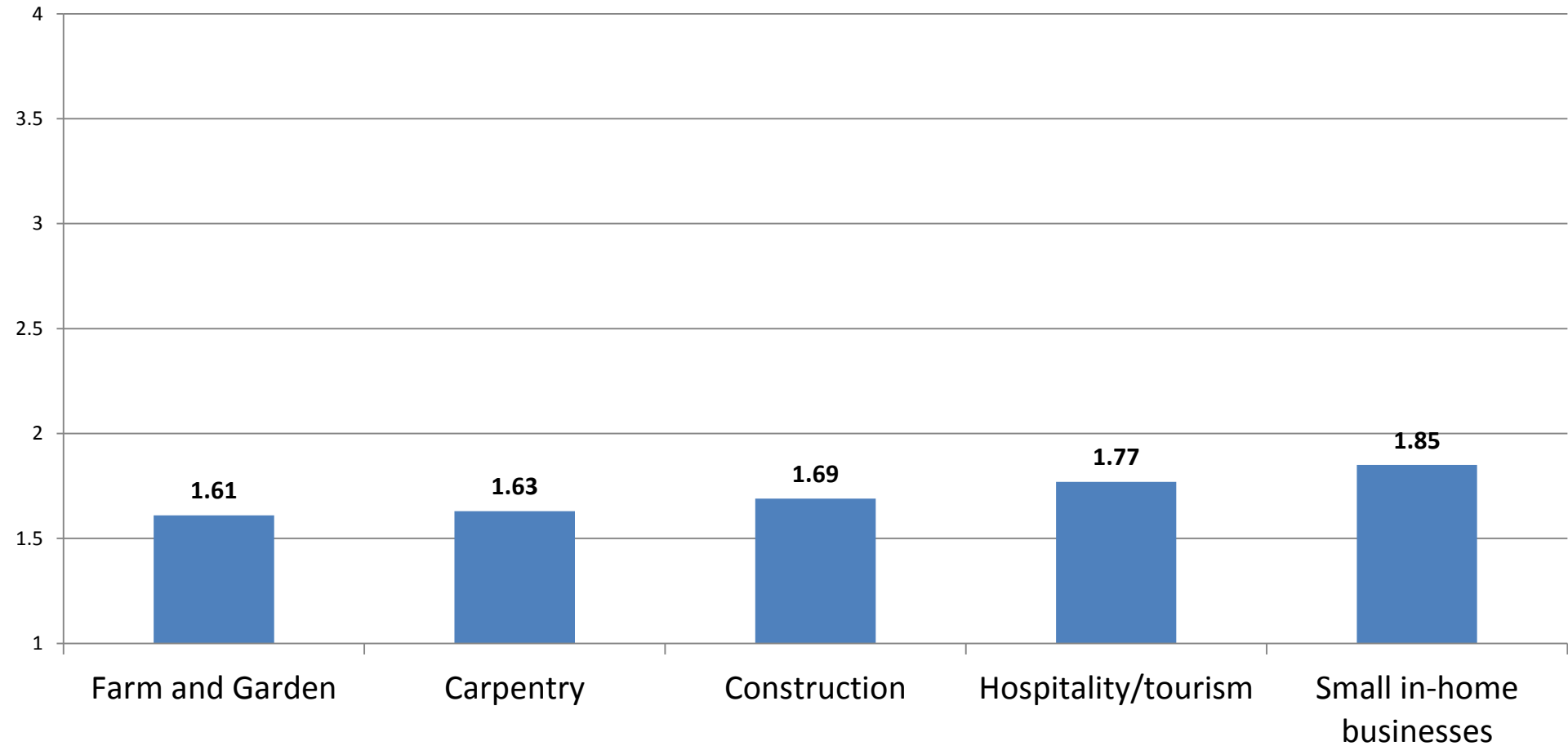

Economic Development: Attitude Towards Types of Tourism

Greatly Encouraged (1) → Greatly Discouraged (4)

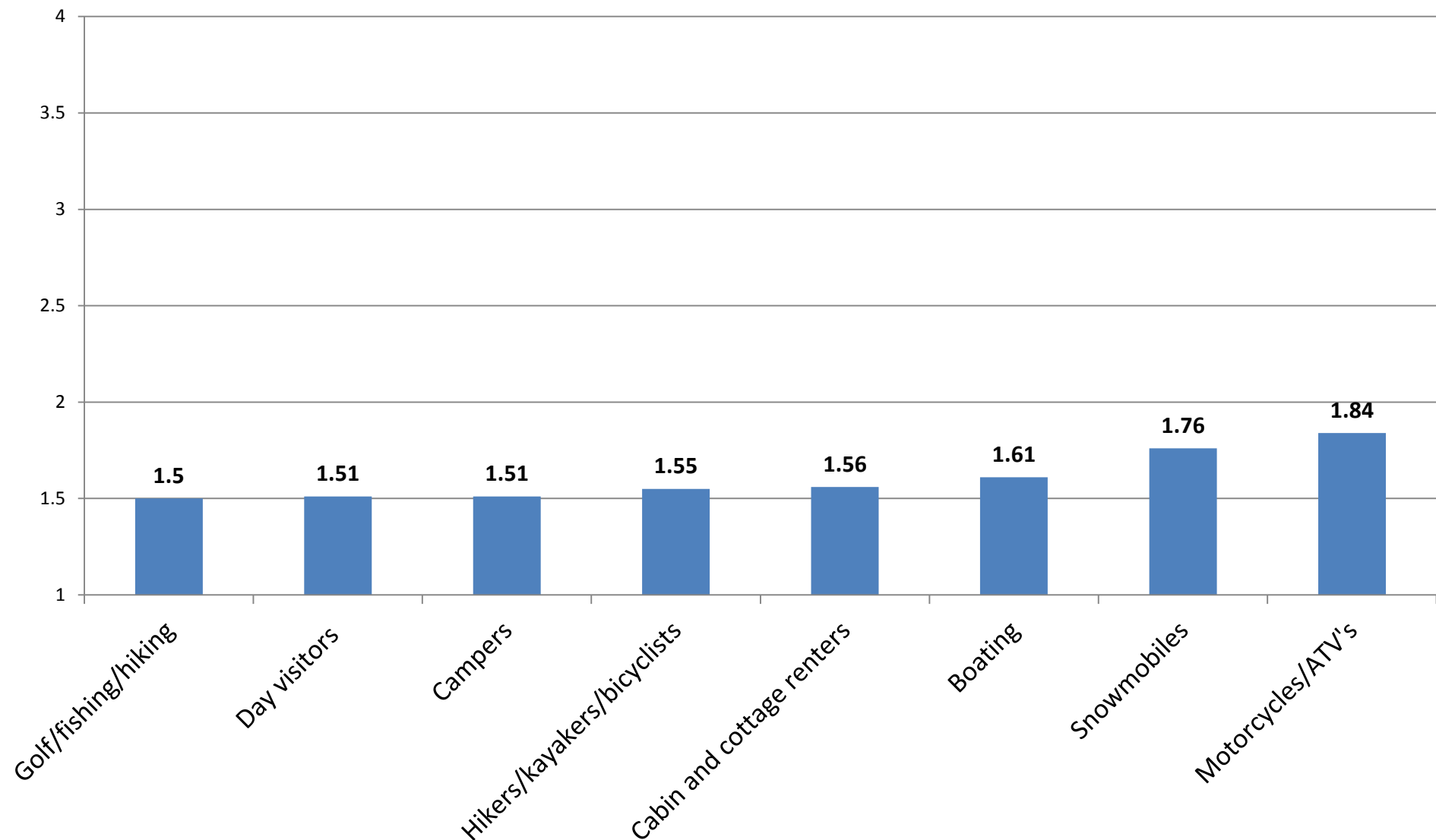

“Protect our natural environment when considering any economic development”

Town Facilities



mellendiggers.org



Source: mellen.wislib.org

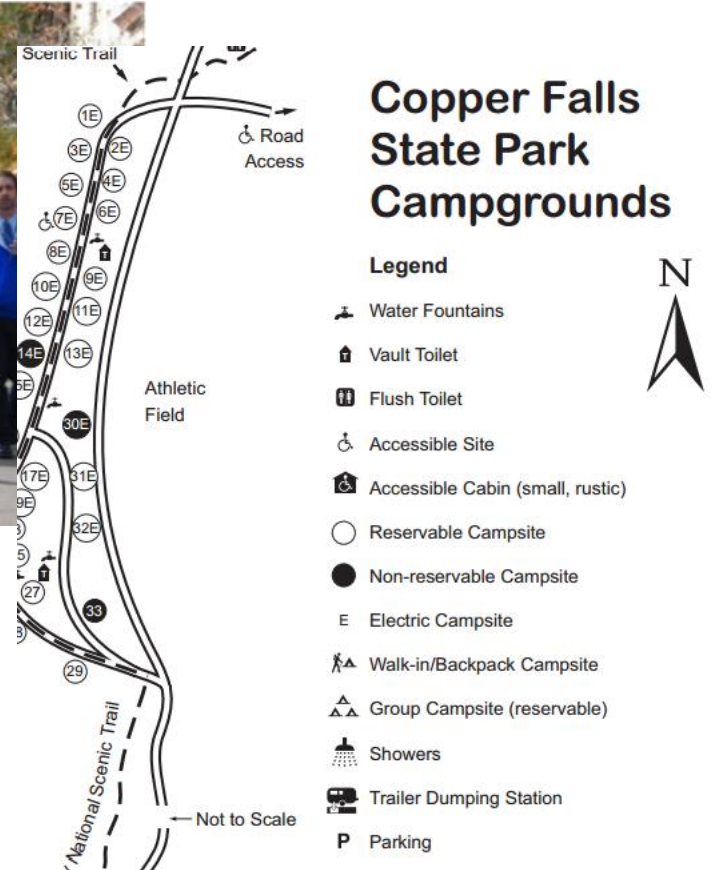

Source: Wisconsin Department of Natural Resources

Community Services/Facilities: Opinion on Local Services

Excellent (1) → Poor (4)

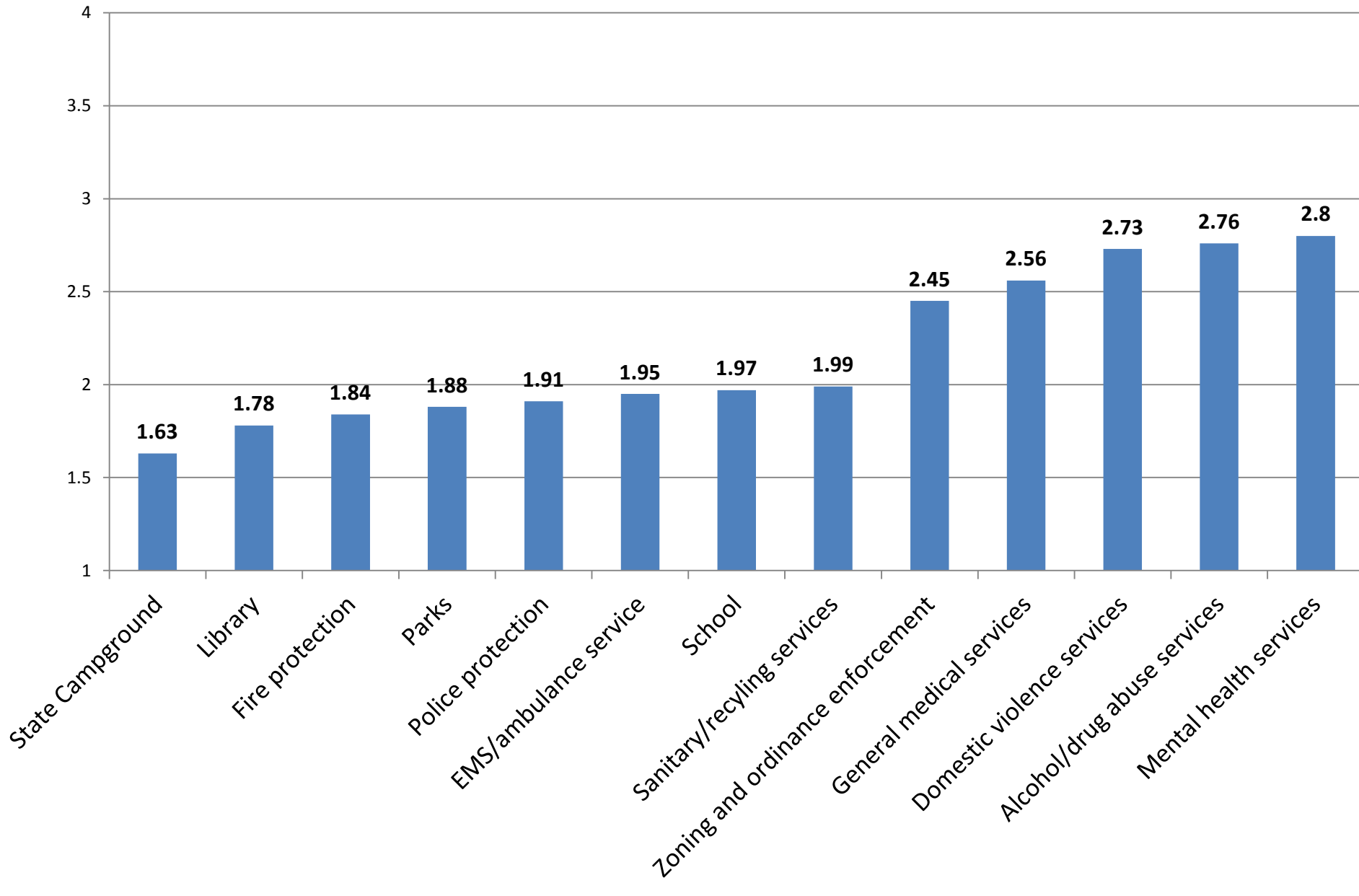

General medical services

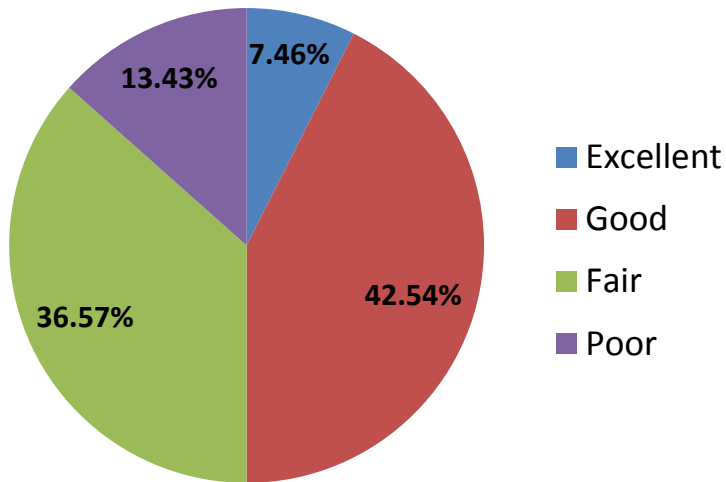

Alcohol/Drug Abuse Services

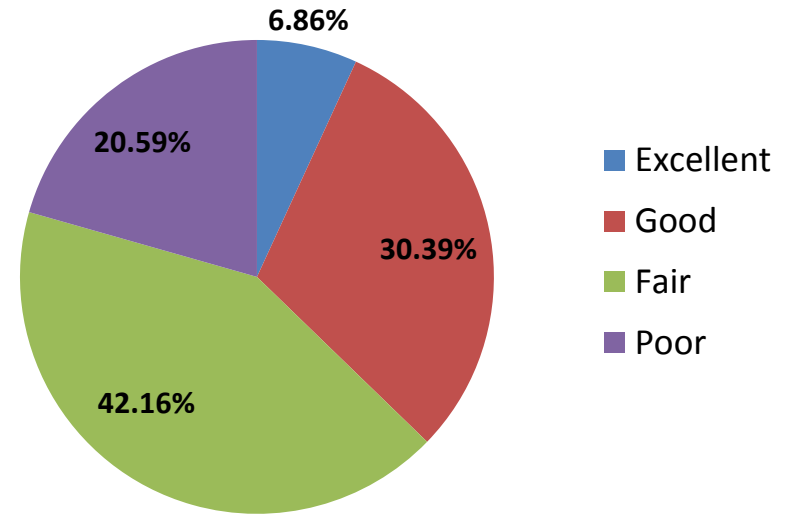

Mental Health Services

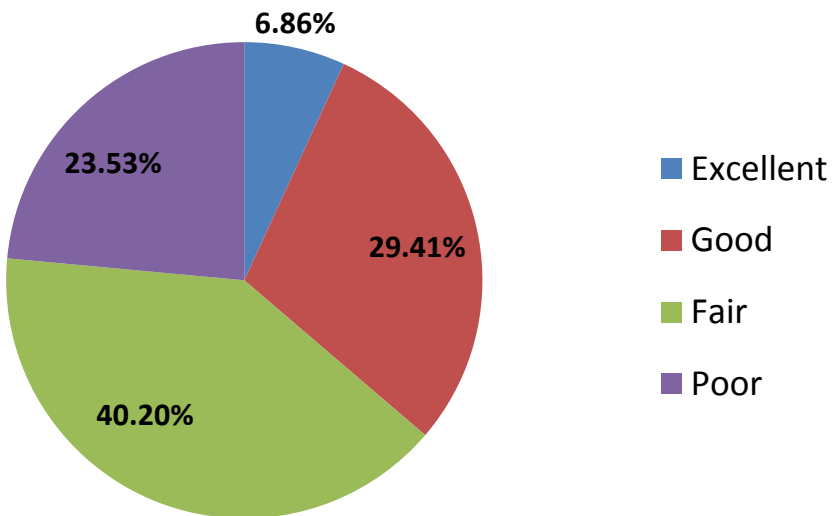

Domestic Violence Services

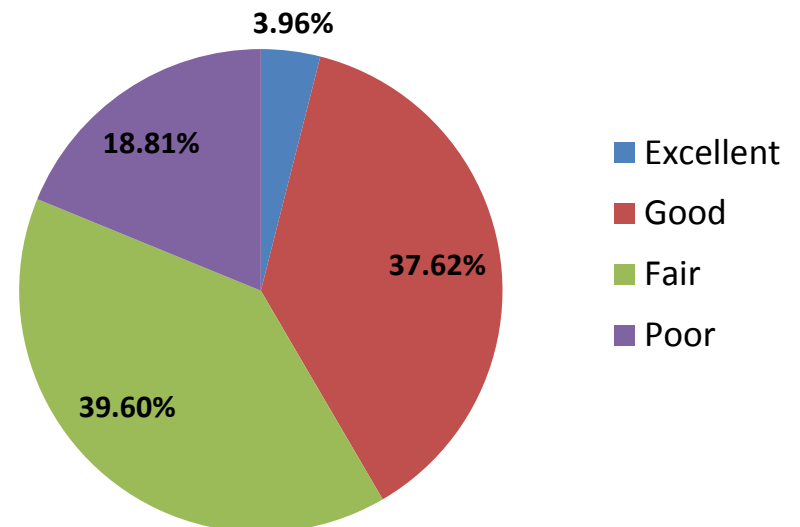

“Hard to answer - How do you define ‘local services’? Example - Ashland has excellent medical. Locally, no medical services”

Support Services



Source: www.meusu.com



Source: apg-wi.com

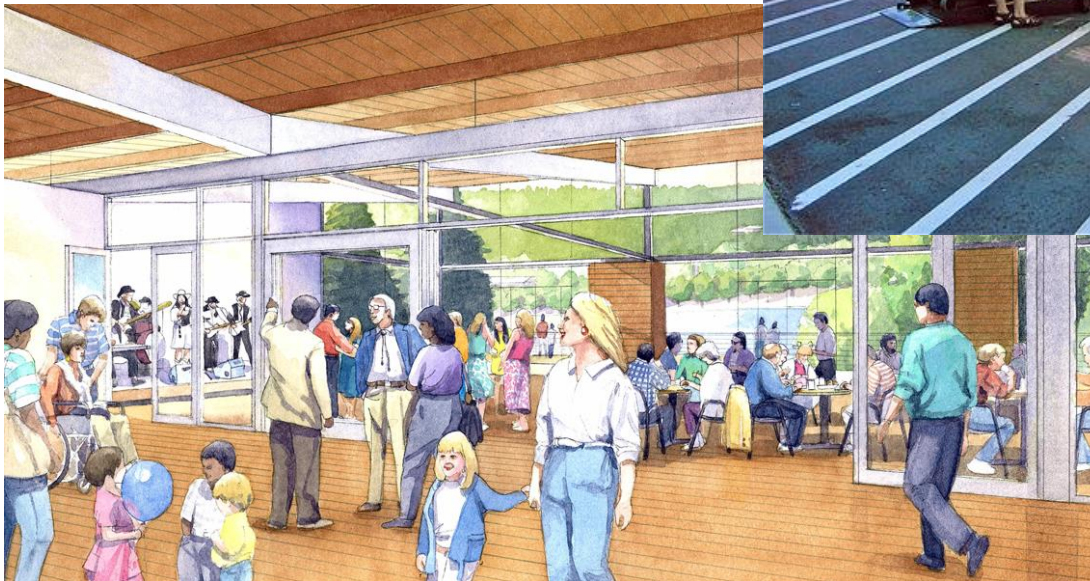

Source: opsisarch.com

Support Services Needed to Continue Living in Town

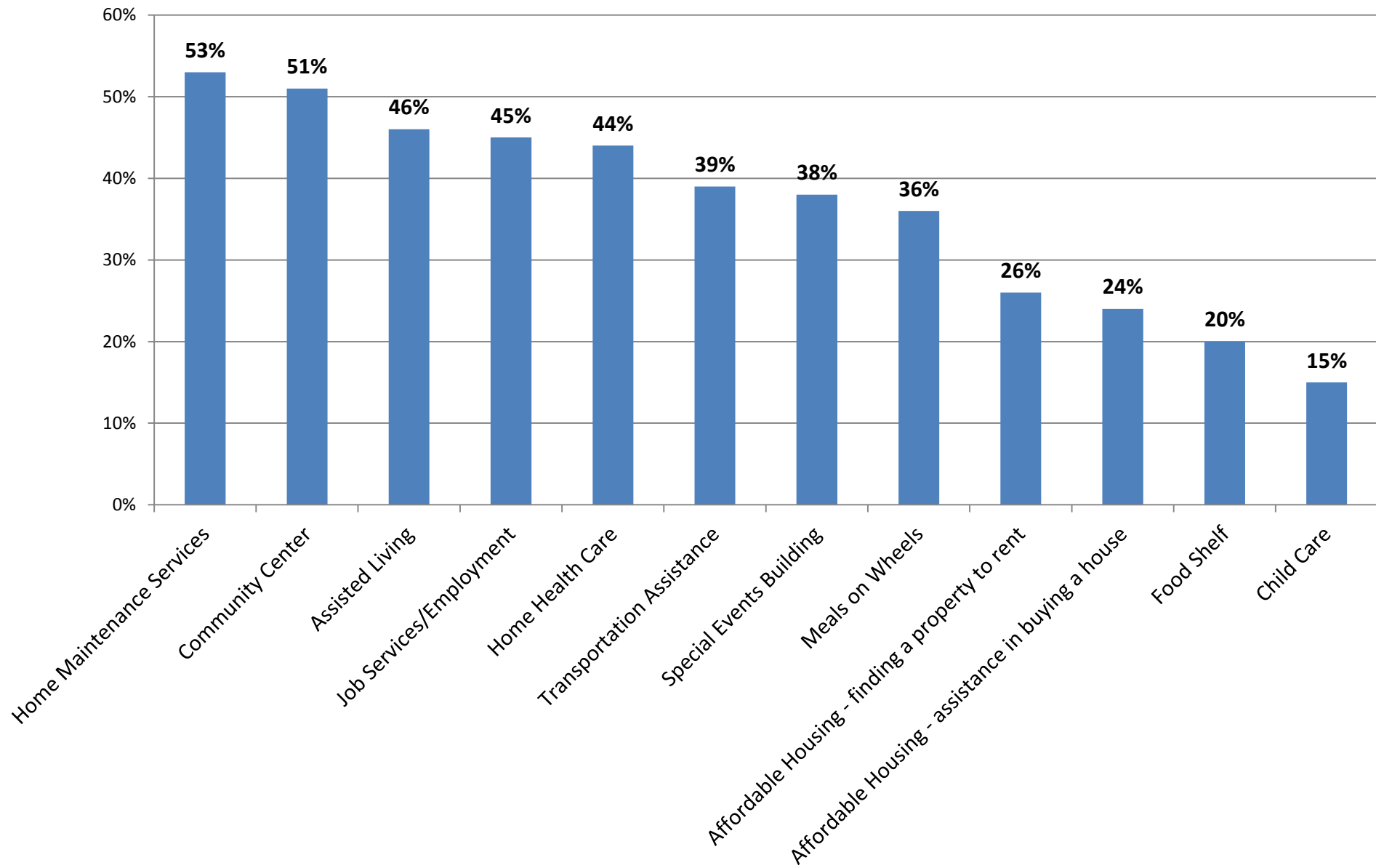

“OK now, in future may need elder home health, transportation to Ashland, etc.”

Preserving Natural Resources



Should the following resources be preserved and enhanced, and how would you fund their preservation? (Check one on each line)

	Yes, fund with local tax dollars	Yes, fund with private dollars	Combined public and private dollars	No, not important to me
Community owned gardens	9.03%	20.14%	23.61%	47.22%
Forests	27.66%	17.73%	48.23%	6.38%
Wetlands	31.21%	9.22%	43.26%	16.31%
Lakes and streams	38.03%	8.45%	49.3%	4.23%
Farmland	4.38%	56.2%	27.74%	11.68%
Community open/greenspace	23.36%	8.03%	37.23%	31.39%
Parks and public boat landings	44.68%	1.42%	51.06%	2.84%
Public trail system for walking, skiing, biking, birding, etc.	30.34%	4.83%	48.28%	16.55%

***“A good biking/walking trail between
Mellen and Copper Falls”***

***“More open spaces for the public to fish
from shore on local lakes”***

Internet Carrier

“Internet access in my area is available only via mobile carrier or satellite, and is both slow, expensive, and data-limited. This puts the area at a huge disadvantage for economic development, education, etc.”

Questions/Comments?

Tom Wojciechowski

715/682-7017 ext.514

tom.wojciechowski@ces.uwex.edu

Natalie Cotter

715/682-7017 ext.511

natlynn.cotter@gmail.com